

A1

DO NOT SCALE

File: 5214419-ATK-01-ZZ-DR-CE-0501_0502.dwg
Date: Sep 17, 2022 - 3:54pm
Printed by: patrick.sheridan

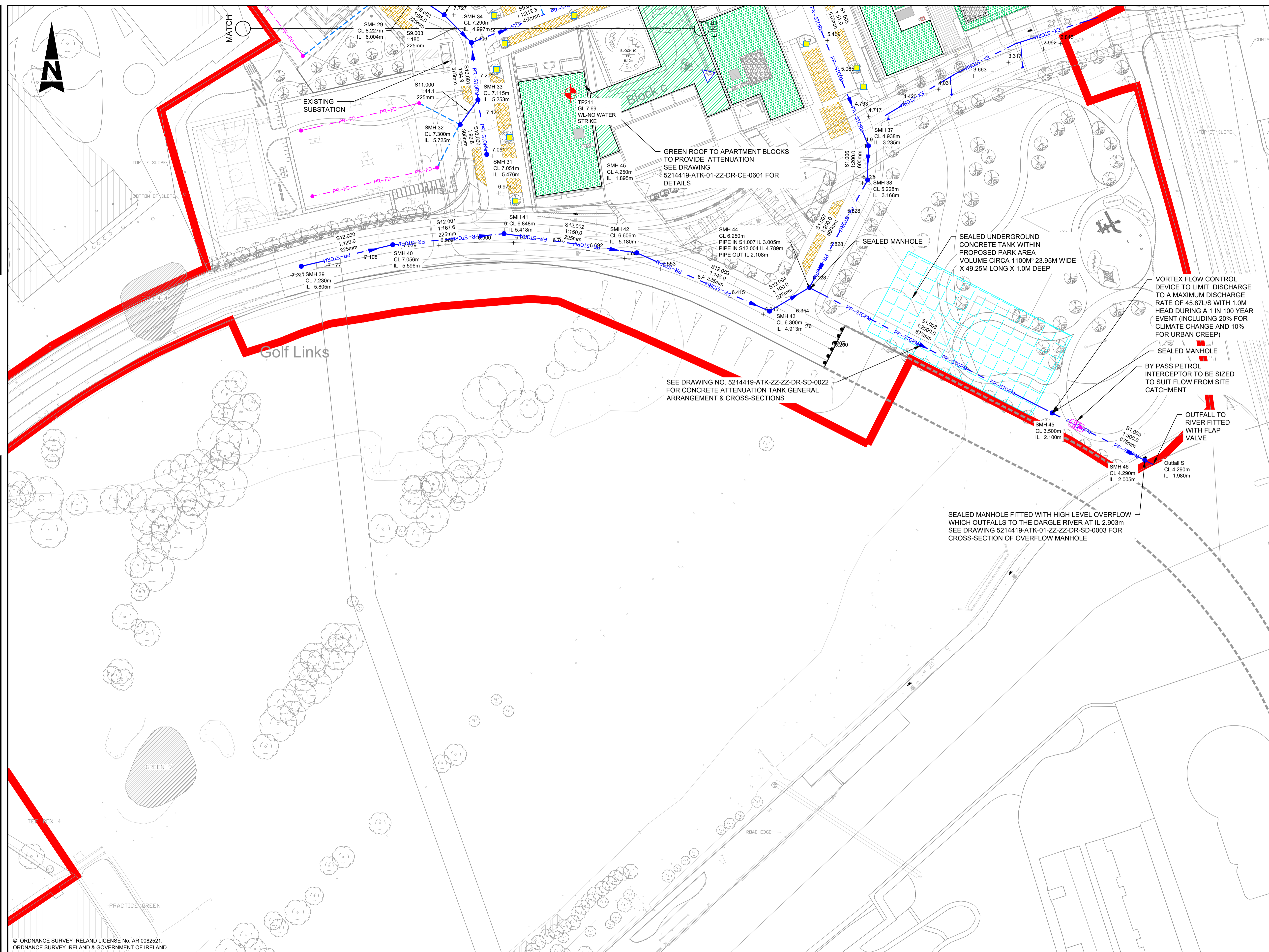

- GENERAL NOTES**
1. ALL DIMENSIONS ARE IN MILLIMETRES UNLESS NOTED OTHERWISE
 2. ONLY WRITTEN DIMENSIONS SHALL BE USED. NO DIMENSIONS SHALL BE SCALED FROM THE DRAWINGS
 3. ALL LEVELS ARE IN METRES AND ARE TO MALIN HEAD DATUM
 4. ALL COORDINATES ARE IN METRES AND ARE TO IRISH TRANSVERSE MERCATOR

- NOTE:**
1. THE SURFACE WATER DRAINAGE NETWORK IS TO BE DESIGNED AND CONSTRUCTED IN COMPLIANCE WITH THE 'REGIONAL CODE OF PRACTICE FOR DRAINAGE WORKS VERSION 6.0'
 2. NO SURFACE WATER/RAINWATER TO DISCHARGE INTO THE FOUL SEWER SYSTEM UNDER ANY CIRCUMSTANCES.
 3. ALL RWP, GULLY AND CHANNEL DRAIN CONNECTIONS TO THE MAIN SURFACE WATER DRAINAGE SYSTEM ARE TO BE ACHIEVED VIA DIRECT CONNECTION TO THE MANHOLE AT LEVELS SOFFITS OR VIA SADDLE CONNECTION TO THE STORM SEWER PIPE.
 4. ALL GULLIES TO HAVE SEPARATE CONNECTIONS TO THE STORM DRAINAGE NETWORK.

LEGEND

	SITE BOUNDARY		PROPOSED UNDERGROUND ATTENUATION SYSTEM
	PROPOSED STORM DRAINAGE		PROPOSED PERMEABLE PAVING
	PROPOSED STORM WATER MANHOLE		PROPOSED INTENSIVE GREEN COURTYARD
	PROPOSED ROAD GULLY		PROPOSED EXTENSIVE GREEN ROOF
	PROPOSED INSPECTION CHAMBER & FILTER DRAIN		EXISTING STORM DRAINAGE
	PROPOSED COLLECTOR DRAIN		SITE INVESTIGATION TRIAL PIT LOCATION
	PROPOSED SWALE & PERFORATED MANHOLE COVER		
	PROPOSED TREE PIT LOCATION		

ATKINS
Member of the SNC-Lavalin Group

Atkins House, 150-155 Ainslie Road, Dublin 15
Tel (+353) 01 810 8000 Fax (+353) 01 810 8001

Unit 2B, 2200 Cork Airport Business Park, Cork
Tel (+353) 021 429 0300 Fax (+353) 021 429 0360

1st Floor Technology House Parkmore Technology Park, Galway
Tel (+353) 091 786 050 Fax (+353) 091 779 830

Client: SHANKILL PROPERTY INVESTMENTS LTD

Project: COASTAL QUARTER SHD 2

Purpose: PLANNING		Title: PROPOSED STORM WATER LAYOUT SHEET 2 of 2	
Original Scale: 1:500 at A1 1:1000 at A3	Design/Drawn: PS Date: 26.05.22	Checked: AC Date: 26.05.22	Authorized: GH Date: 26.05.22
Status: P	Drawing Number: 5214419-ATK-01-ZZ-DR-CE-0502	Rev: P01	